

Ansell Lighting strengthens high impact offering

4 hours ago

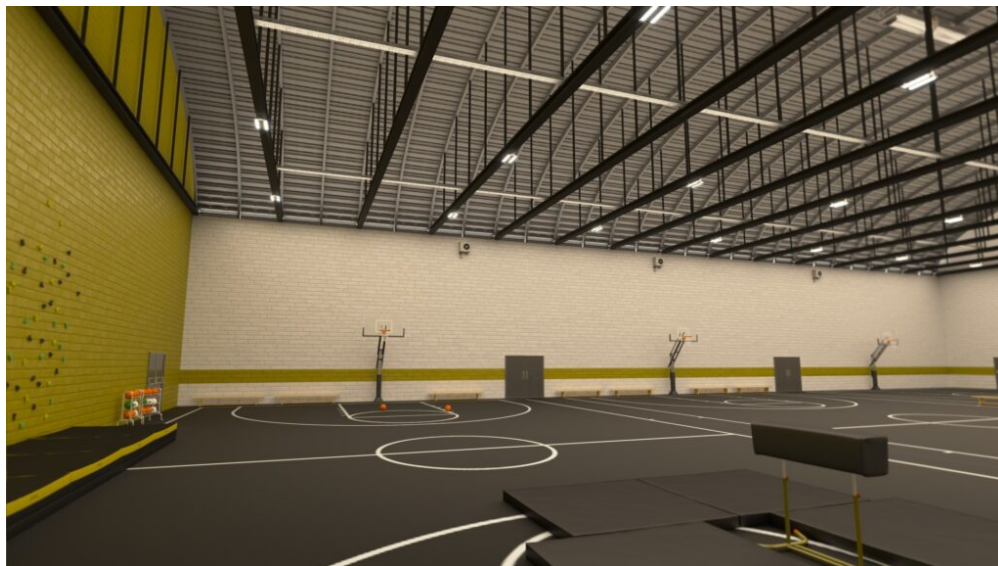

The ideal solution for high-impact spaces such as sports halls and outdoor pitches, [Ansell Lighting](#) has added two new robust luminaires to its lighting range.

Designed specifically for large, outdoor areas, the Exa floodlight is manufactured from coastal marine grade aluminium and finished with a premium AkzoNobel anti-corrosion powder coating, offering exceptional durability. Combining strength with outstanding performance, it offers a powerful high-lumen package ranging from 60,000 lumens (400W) up to 180,000 lumens (1200W).

A range of accessories are also available to further enhance Exa's performance, including a narrow beam lens to minimise light spill and a floodlight visor for glare control. An innovative magnetic aiming device also aids fast and accurate installation, ensuring greater precision on site.

Providing an equally robust and powerful option for demanding indoor spaces, Ansell Lighting has also unveiled Ocu-Lux, a multi-wattage linear high-bay that combines impact resistance with superior performance.

With an outstanding 185 lm/W efficacy, Ocu-Lux delivers maximum energy savings and is fully tested and approved to DIN18032-3 for ball impact resistance. Suitable for suspended or surface mounting, it is OCTO-ready and has Zhaga sensor ports for flexibility and control.

Ocu-Lux also offers a choice of wattage options – 160W, 120W, 80W – providing flexibility for varied mounting heights and lux requirements. Quick and easy to install, it also features a rear fast connector plug, while 1-10V dimming comes as standard.

Mark Abbott, Managing Director at Ansell Lighting, said: " There is a lack of robust, high-performance

solutions in the market that can meet the challenges of both high-impact indoor and outdoor environments in education and sports settings. Exa and Ocu-Lux address that gap, combining durability, efficiency and flexibility with simple installation and control options.”