

Tilbury Douglas Secures Place on the Department for Education's Latest Framework

4 hours ago

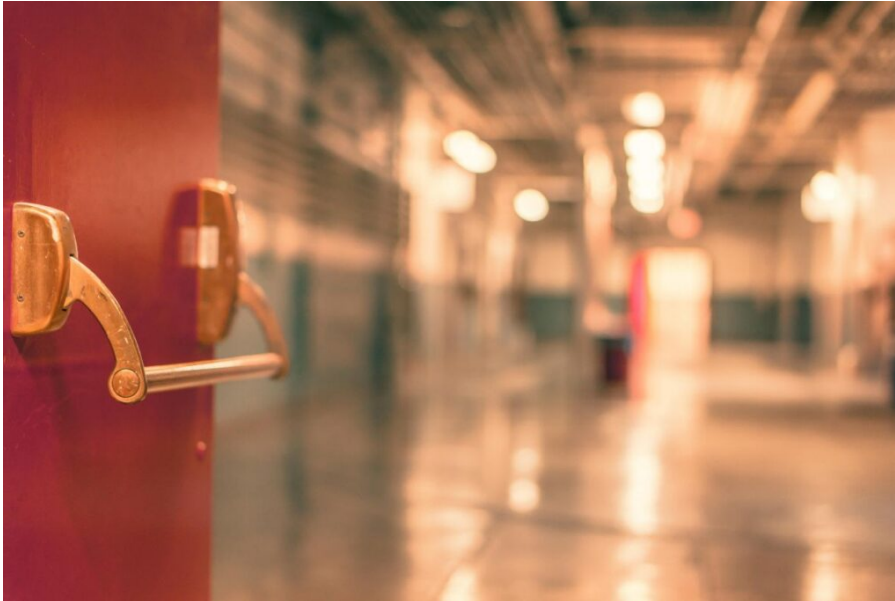

Tilbury Douglas, a leading UK building, infrastructure, engineering and fit-out business, has secured a place on the Department for Education's (DfE) new £15.4bn Construction Framework 2025 in the High Value Band (above £12m) for the North and South lots.

The eight-year programme will support the delivery of new educational facilities across England and will be procured under the Procurement Act 2023. The framework comprises an initial six-year term with the potential for two one-year extensions.

Projects will include secondary schools, academies, further education colleges, Special Educational Needs and Disability (SEND) schools, and other educational facilities, supporting the DfE's commitment to modern, sustainable and future-ready learning environments.

Craig Tatton, Chief Executive Officer at Tilbury Douglas commented: "We are delighted to have secured a place on this significant framework, reaffirming our position as one of the UK's leading education contractors. Working collaboratively with the DfE, our clients and our supply chain, we look forward to delivering high-quality educational facilities that set new standards for net-zero performance, innovation and long-term value."